

MANUAL FOR EXHIBITING COMPANIES



www.fpcc.at

Important Contact Details

Conference Venue

Ferry Porsche Congress Center (FPCC)
Congress Center GmbH Zell am See
Brucker Bundesstr. 1a, 5700 Zell am See
Austria

T: +43-(0) 6542 474 75 0

E: info@fpcc.at / www.fpcc.at



Catering

Wimreiter KG
Event Cars - Mobile Bar, Event & Catering Service
Kollingweg 438
A-5754 Hinterglemm
Mail: office@event-cars.at
Tel.: +43 664 522 89 02



General Information

Ferry Porsche Congress Center (FPCC)
Brucker Bundesstr. 1a, 5700 Zell am See, Austria

Arrival

Coming from Vienna:

A1 - St. Pölten - Salzburg A 1/ E 55 - Reichenhall A
8 - Steinpass B 312 - Unken - Zell am See B 311

Coming from Munich:

Munich A8 - Autobahndreieck Inntal A8 - Traunstein
B 306 - Exit Siegsdorf - Steinpaß B 312 - Unken -
Zell am See B 311

Coming from Zurich:

Zurich A1 - Winterthur A1 - St. Gallen A1 - Feldkirch
A 14 - Bludenz A14 - Landeck Inntalautobahn - Imst - Innsbruck B 312/E 60 - Abfahrt
Wörgl - Kitzbühel B 161 - Paß Thurn - Mittersill B 168 - Zell am See B 311

Coming from Milan:

Milano / Milan P14 - Brescia A 4 - Trient A 22 - Bozen A 22 - Sterzing
Brennerautobahn - Innsbruck Inntalautobahn - Abfahrt Wörgl - Kitzbühel B 161 - Paß
Thurn - Mittersill B 311 - Zell am See B 311



City Map Zell am See



Parking

Cars:

Underground Car Park Congress Center (APCOA)

Brucker Bundesstraße 1a, 5700 Zell am See, Austria

Telephone: +43 6542 72807 11

Opening hours: 0 - 24 / Parking spaces: 396 / Entrance height: 2,10 m

Tariff: per hour EUR 2,60 / Daily max: EUR 20,80 (referring to July 2019)

Reduced tariffs upon consultation.

Truck:

There are 5 parking slots free of charge (for 1 week) next to the ice rink/indoor swimming pool (5 minutes walking distance to the Congress Center). If you want to park there please get in touch with us and we will ask the city of Zell am See for permission.

Information regarding set-up and tear-down

Please stick to the official times regarding set-up and tear-down. Stands which are not degraded in time will be removed at the owner's expenses.

Ban on driving for trucks above 7,5 tons:

Saturday from 3 pm until Sunday 10 pm trucks are not allowed to drive in Zell am See.

Application for a special permit:

BH Zell am See (Bezirkshauptmannschaft Zell am See)

T: +43 6542 760 06

Please inform yourself about any bans on driving for trucks in Austria.

Information about delivery and collection

Delivery/Collection

Deliveries are only possible on the official set-up-days. Please keep in mind that deliveries should be made to your exhibiting space only. Deliveries through haulage firms are possible as well. A clearly visible caption and addressing is essential:

Congress Center GmbH Zell am See

z.H. **Company Name**

****Event Name****

Brucker Bundesstr. 1a,

5700 Zell am See

AUSTRIA

The collection of your stuff must be done on the official day of the tear-down. If your equipment is getting picked up by a hauling firm please have it packed and addressed.

Vehicle access / Loading and Unloading

Every truck drivers must announce their arrival in the office of the Ferry Porsche Congress Center. We will show you a place for loading or unloading. Alle LKW Chauffeure müssen sich nach Ankunft im Büro des FPCC's anmelden. The vehicle access is possible for trucks up to 42 tons.

Loading and Unloading for cars

Via the underground car park (at the owner's expenses) with the elevator directly to the show floor. Entrance height 2,10m.

Elevator measurements: Door width: 0,9 m / Door height: 2,1 m / cabin depth: 2,1 m / -width: 1,1 m / -height: 2,1 m / 1 t payload

Please keep in mind: You can only park your car/truck at the loading/unloading area during while you are loading or unloading the car or truck.

Please keep in mind that we do not have any forklifts, pallet trucks or any other trollies.

Storage facility

We do not have any storage facilities for your equipment..

Information for stand construction

Floor plan Ferry Porsche Congress Center

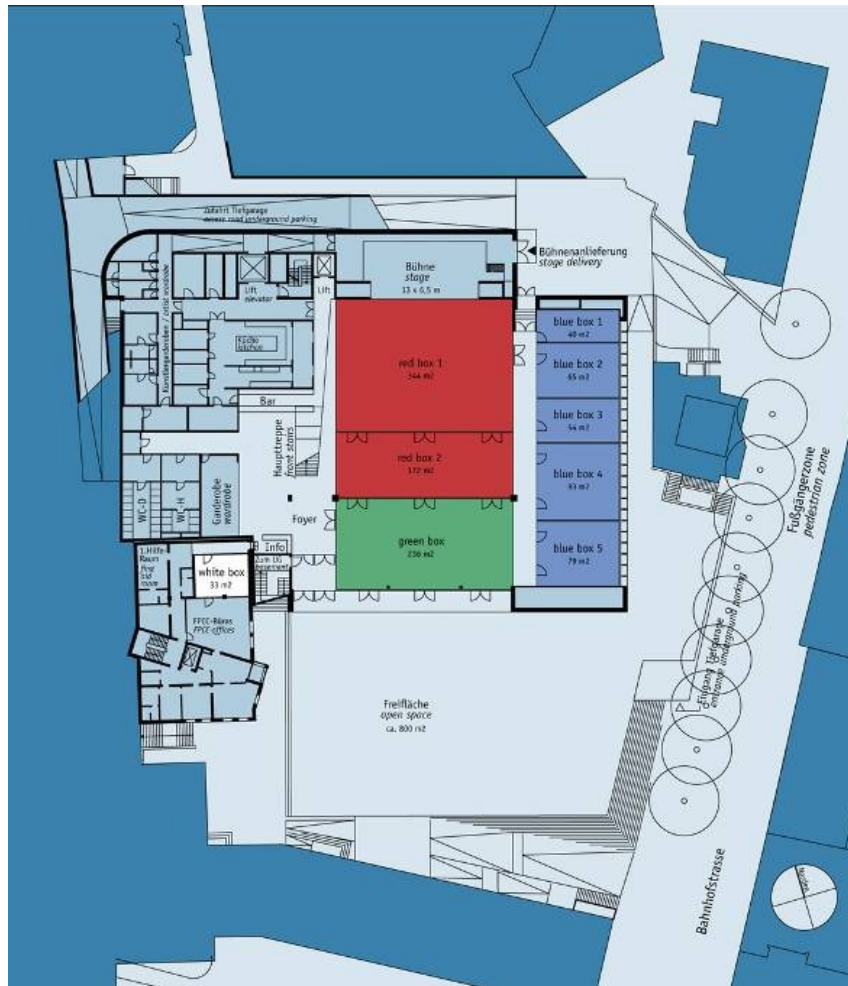

Flooring

Red Box 1+2, Green Box, Foyer und Blue Box 1-5: block parquet glued (Amerikan cherry oiled); Floor Loading: 500 kg / m²

Please take care of our floor and act carefully. If you bring anything with a sharp metal base you must bring an appropriate base to protect the floor. Avoid point loadings.

Carpeted floors and other floors have to be layed in an accident-proof way. They are not allowed to be bigger than your stand. If you bring a double-sided tape take care that it can be removed without any traces. Non-removed impurifications will be removed at the owner's expenses.

Ceiling heights

Red Box 1+2: 8,70 m
Green Box, Blue Box 1-5: 3,50 m
White Box: 2,80 m
Foyer EG in front of the Bar: 2,60 m
Foyer OG Entrance: 4,70 m

Please keep in mind: You have only booked a floorspace – anything else like dividing walls, exhibiting booths, electrical connections, cleaning of your stand or any kind of furniture is not included. If you need anything of those things you can order them with your order sheet.

Construction plans including heights and points of installations (electricity, internet) have to be sent over to the Ferry Porsche Congress Center for approval.

Suspensions & Attachments

Suspensions from the ceiling are not possible. Every stand has to be self-supporting. Attachments to the walls, columns and floors are forbidden. The exhibitor is liable for any damages.

Other Informations & Regulations

Waste Disposal

Due to the provision of law the event organiser is responsible for the disposal of waste which is made because of the conduction of the event, the set-up or the dear-down. The arising waste has to be separated (paper, cardboard boxes, glass, metall, plastic, etc.). If the waste is not removed and/or separated the Ferry Porsche Congress Center will remove and separate it at the owner's expenses.

Electrical installation

The laying of conductions outside of the stand and connections to the supply network can only be made by the Ferry Porsche Congress Center.
If you need an electrical connection at a specific point please get in touch with us two weeks before the event.

Lightning

The general lightning in the Ferry Porsche Congress Center may not be enough to illuminate single stands efficient.

Fire Safety Regulations

Everything you use for your stand has to be non-inflammable, fireproof, self-extinguishing (plastic material) or has to be made fire-resistant trough impregnation. Please have the proofing certificates ready at your stand. It is forbidden to use any open fire or light (spirit, fuel, etc.). Fire extinguisher, flame detectors or other safety installations must be kept clear all of the time. Aisles and exits have to be clear all of the time and cannot be misplaced with anything.

Supplementary Orders

Furniture (tables, chairs, etc.) – please ask the Ferry Porsche Congress Center

Technique - please ask the Ferry Porsche Congress Center

Cleaning of your stand - please ask the Ferry Porsche Congress Center

Flowers and Plants

Blumen Riegler

Prof. Ferry Porsche Straße 18, 5700 Zell am See /T:+43 6542 - 57 291

Gärtnerei Schwaighofer

Weikersbach 18, 5760 Saalfelden am Steinernen Meer / T: +43 6582 72401-51

Security

The exhibition stands and all its appendant exhibitions pieces are not covered by insurance. We are not liable for any loss or damage.

The exhibitor is liable for any damages which are made by him or herself or the employees or visitors.

We recommend you to lock valuable goods if you are not at your stand.

You have to follow the instructions of the employees of the Ferry Porsche Congress Center. Keep all the aisles and exits clear at all time! The terms and conditions of the Ferry Porsche Congress Center must be observed. You can read about them here:

<https://www.fpcc.at/en/facts-figures/business-conditions/>

Smoking

Smoking is not allowed in the Ferry Porsche Congress Center.

Catering

The Ferry Porsche Congress Center has an exclusive Catering Partner – as seen on Page 2.

Catering at your stand

If you would like to serve food and beverages at your stand you have to order them at our catering partner. If you want to bring your own products please get in touch with our catering partner. If you do not have an agreement about that with our catering partner, he will be likely to send you an invoice about their amount of work and an instalment payment.

Tablecloths, covers, bar stools or tables can be order by our catering partner as well.